

## Room Numbers by Track and Class Name

|                      | <b><u>Track 1 (Yellow)</u></b><br><b><u>(9:30 SS/11:00 Worship)</u></b> | <b><u>Track 2 (Blue)</u></b><br><b><u>(9:30 Worship/11:00 SS)</u></b> |
|----------------------|---|---|
| <b>Preschool</b>     | <b>9:30 AM</b>  | <b>11:00 AM</b>   |
| Nursery              | A115  | A115  |
| Toddlers             | P106  | P106  |
| 2s & 3s              | P102  | P102  |
| 4s                   | P101  | P101  |
| Kindergarten         | P103  | P103  |
| <b>Children</b>      | <b>9:30 AM</b>  | <b>11:00 AM</b>   |
| Grade 1              | A114 (Grades 1&2)   | A114  |
| Grade 2              | A114 (Grades 1&2)   | C210  |
| Grade 3              | C211 (Grades 3&4)   | C211  |
| Grade 4              | C211 (Grades 3&4)   | C212  |
| Grade 5              | C208 (Grades 5&6)   | C208  |
| Grade 6              | C208 (Grades 5&6)   | C207  |
| <b>Youth</b>         | <b>9:30 AM</b>  | <b>11:00 AM</b>   |
| Grades 7 & 8         |   | Y104  |
| Grades 9 & 10        |   | Y105  |
| Grades 11 & 12       |   | Y103  |
| <b>Adults</b>        | <b>9:30 AM</b>  | <b>11:00 AM</b>   |
| Apprentice           | A123  |   |
| Barnabas             | A110  |   |
| Branches             | A122  |   |
| Deaf                 | A201  |   |
| Faith Growers        | A215  |   |
| Friendship           | A212  |   |
| Grace                | A218  |   |
| Seekers              | A211  |   |
| Single Adults        | A109  |   |
| Agape                |   | A109  |
| Bible Book           |   | A217  |
| Van Voorhis Class    |   | A120  |
| College/Young Adults |   | A202  |
| Explorers            |   | A205  |
| Genesis              |   | A215  |
| Koinonia             |   | A216  |
| Theophilus           |   | A208  |
| The Connection       |   | A218  |

# Education Wing/Fellowship Hall

## First Floor

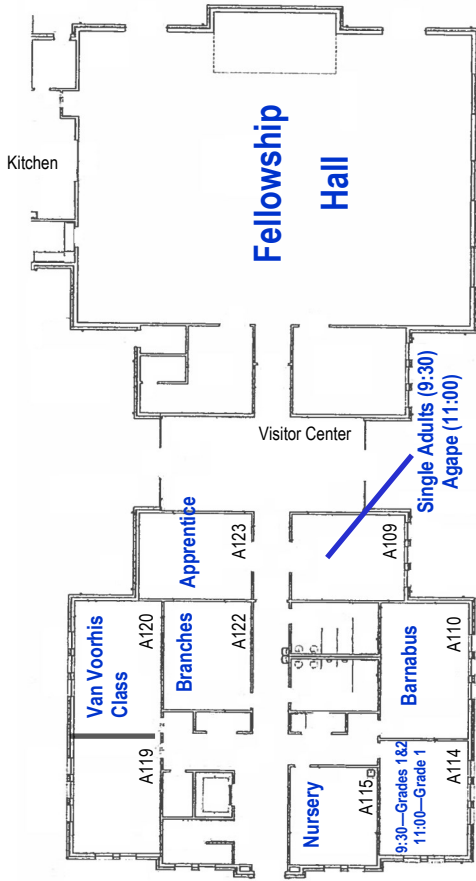

# Education Wing/Fellowship Hall

## Second Floor

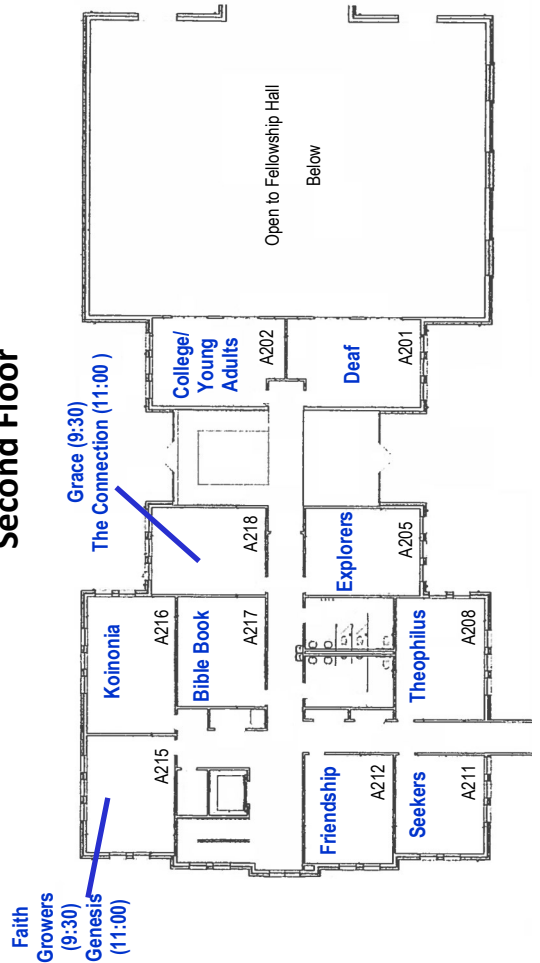

# Main Church Building

## Upper Level

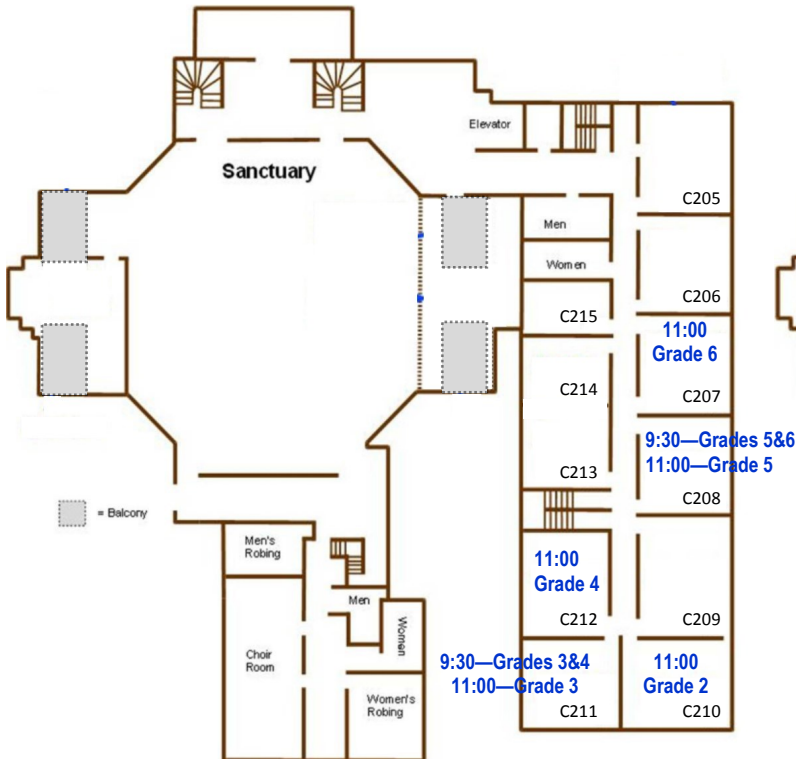

# Main Church Building

## Lower Level

